

# 2-Wire Video Intercom System

## Door Station

---

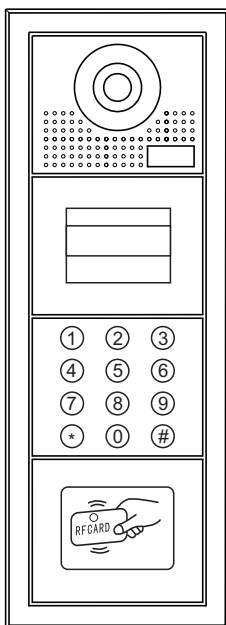

## User Manual

---

Please read this manual carefully before using the product .

# 1. Parts and Functions

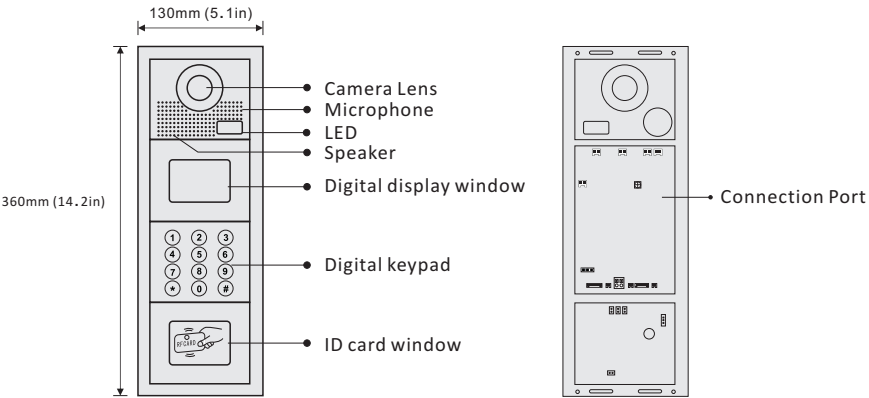

# 2. Terminal Description

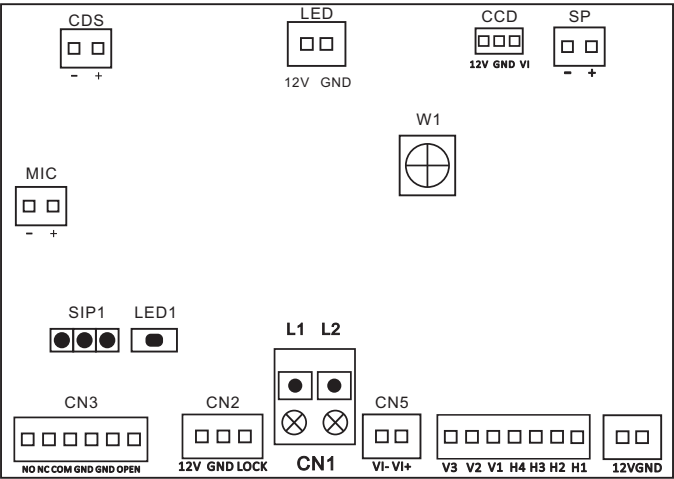

- MIC**: Microphone connection port
- CN3**: Unlock connection part
- W1**: Volume adjustor
- LED**: Night vision light connection port
- CCD**: Camera module connection port
- SP**: Speaker connection port
- CN1**: (L1, L2) non-polarity bus line
- CN5**: Extra camera connection port
- CN2**: Card reader module connection port

# 3. Mounting

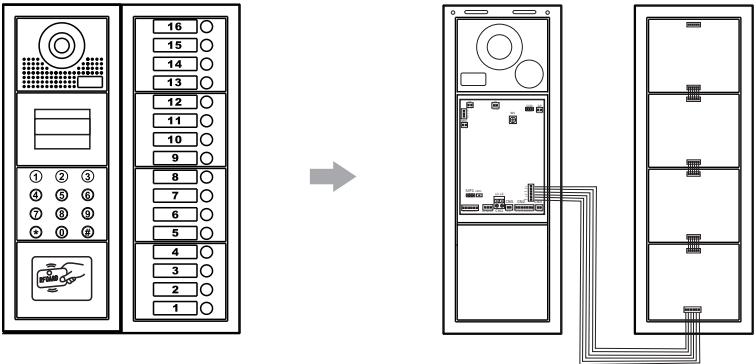
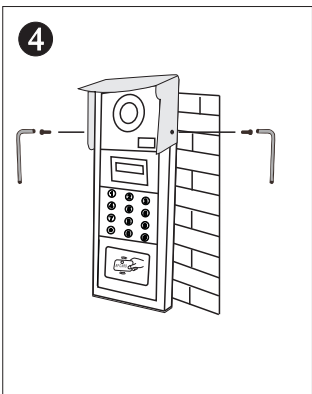
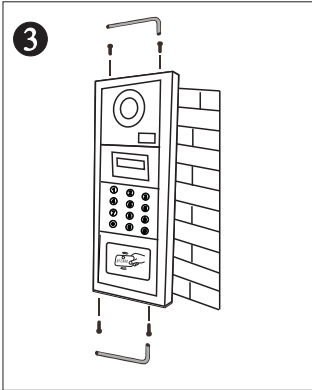
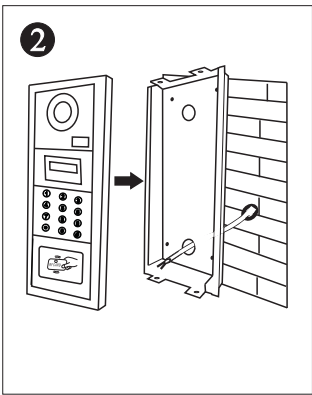
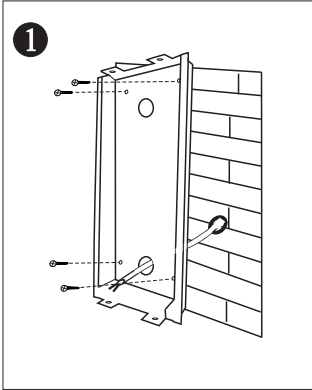

Installation with expanding panel

## 4. System Connection

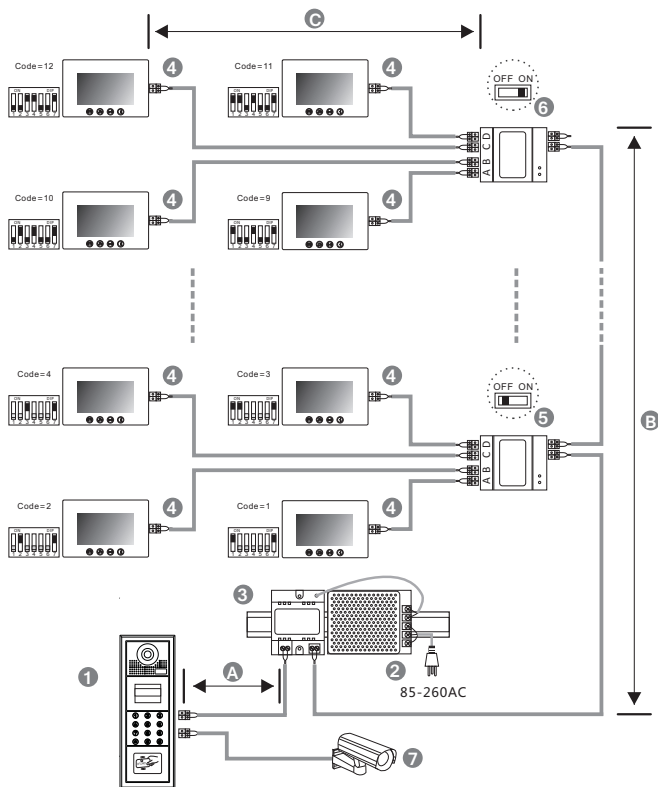

When monitor quantity < 20

Cable usage	A	B	C
Parallel cable 2×0.75mm <sup>2</sup>	60	60	30
Parallel cable 2×1mm <sup>2</sup>	80	80	40

When monitor quantity > 20

Cable usage	A	B	C
Parallel cable 2×1mm <sup>2</sup>	60	60	30
Parallel cable 2×1.5mm <sup>2</sup>	80	80	40

- [1]: Door station.
- [2]: Power supply, **MUST** be installed side by side with Power Separator.
- [3]: Power Separator, **MUST** be installed side by side with Power supply.
- [4]: Monitor, each one with an unique User Code, note that all the bit-6 is the line-terminal switch, set the last monitor to ON, otherwise set OFF.
- [5]: Video distributor set switch to OFF unless at the end of the line.
- [6]: Video distributor set switch to ON at the end of the line.
- [7]: Extra camera.

# 5. Door Station Setting up

The admin password is 1234, \* means confirm, # means back or cancel, 00\* means save and exit.

## How to change admin password?

1\* -> 1234 -> 04\* -> 00\* -> Input 4 digits new admin password -> \* -> #00\*

## Public unlock password

### [1].How to set public password?

1\* -> 1234 -> 04\* -> 33\* -> Input 4 digits password -> \*->#00\*

### [2].How to turn on/off public password function?

1\* -> 1234 -> 06\* -> (Input 8 ON / Input 4 OFF) -> \* -> 00\*

### [3].How to use the public password to open the door?

9\* -> 4 digits password

## Private unlock password

### [1].How to set private password?

1\* -> 1234 -> 04\* -> monitor ID -> \* -> Input 4 digits password -> \* -> #00\*

### [2].How to turn on/off the private unlock password?

1\* -> 1234 -> 05\* -> (Input 8 ON / Input 4 OFF) -> \* -> #00\*

### [3].How to use the private unlock password?

8\* -> monitor ID -> \* -> 4 digits password

### [4].How to change the private unlock password?

4\* -> monitor ID -> \* -> old password -> \* -> new password -> \* -> #

## How to set the unlock time?

1\* -> 1234 -> 02\* -> Input 3 digits unlock number -> \* -> 00\*

Electrical lock input 001-003 , Other lock input 000-250

1 S = 10, for example, 5S = 050 , 10S = 100

## How to set door station ID? (When there's multi door station in the system)

1\* -> 1234 -> 10\* -> Input Door Station ID 1~8 -> \* -> 00\*

## How to restore factory setting? (It takes about 10 seconds to restore to factory setting)

1\* -> 1234 -> 03\* -> 1234 (Wait 10 seconds) -> 00\*

## How to turn on/off extra camera?

1\* -> 1234 -> 11\* -> (Input 8 ON / Input 4 OFF) -> \* -> 00\*

## How to input the user's name?

1\* -> 1234 -> 08\* -> Input monitor ID

-> \* -> Input name -> \* -> #00\*

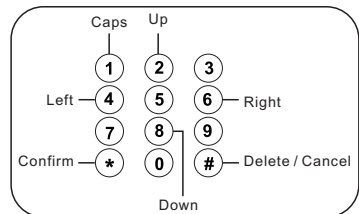

\* Input user's name

# 6. Door Lock Connections

## Internal power supply mode

- 1. The door lock power for a 12v DC strike (max current=250mA).
- 2. Set the jumper SIP1 to 1-2 for a normally closed lock (power OFF to open), or set SIP1 to 2-3 for a normally open lock(power ON to open).

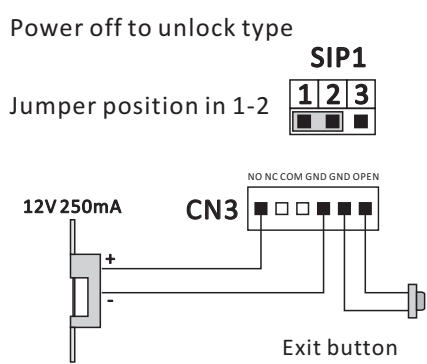
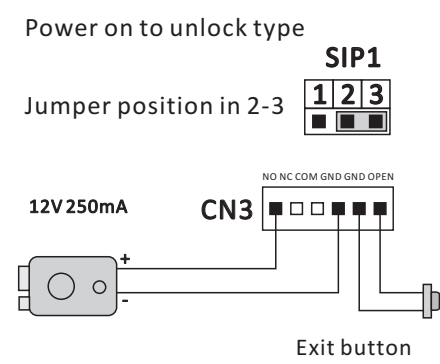

## External power supply mode

When the electronic lock is over 12Vdc, additional power supply for the lock is needed. The jumper must be removed when using external power supply.

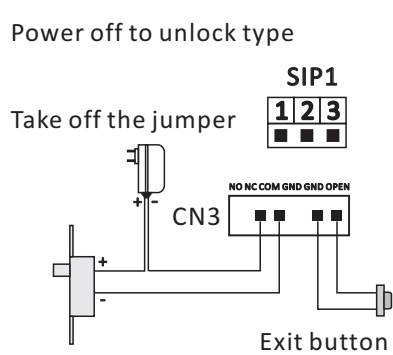
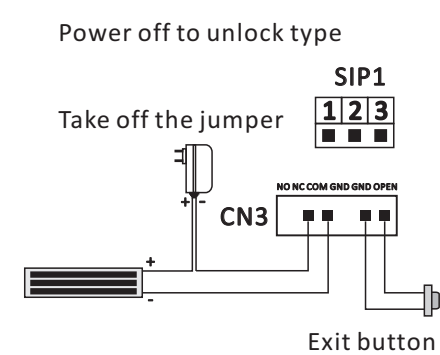

## 7. Specification

---

Power Supply	DC 24V
Power Consumption	Standby 1W, working status 8W
Wiring	2 wire (non-polarity)
Installation	Surface & Flush mounting optional
Unlock Power output	12V DC, 250 mA
Unlock timing	1 ~ 25s
Operating Temperature	-20°C ~ +55°C
Dimension	360(H) × 130(W) × 52(D)mm 14. 2 (H) × 5. 1 (W) × 2. 0(D)in
Embedded Dimension	350(H) × 110(W) × 33(D)mm 13. 7 (H) × 4. 3 (W) × 1. 3(D)in